

LOCKED

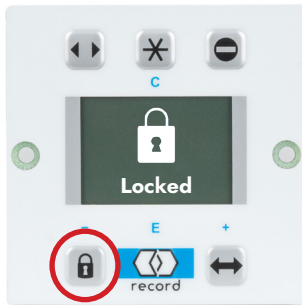

Night Setting To Close The Door

AUTOMATIC

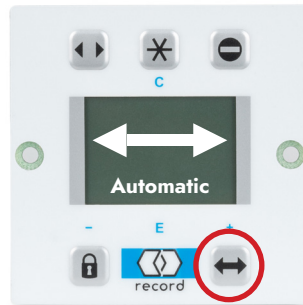

Normal Daytime Operation

NO ENTRY



People Can Leave But Not Enter

WINTER MODE

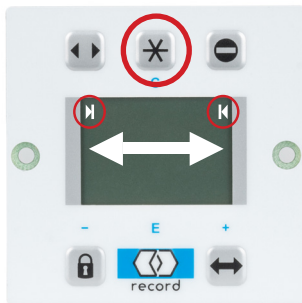

Reduced Opening Size For Heat Saving

HOLD OPEN

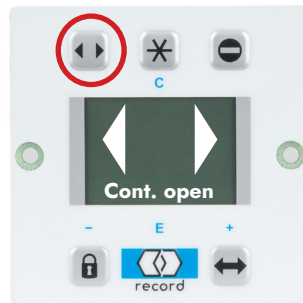

Press The Hold Open Button Once

MANUAL

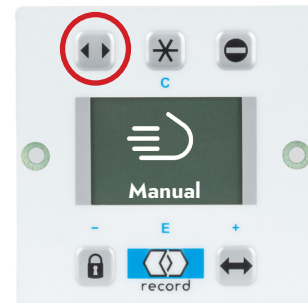

Pressing The Hold Open Button Twice Puts The Door To Manual Operation

To lock the programme selector



A cross symbol will show on the left side of the screen.

To unlock the programme selector repeat the same procedure as above and the cross will disappear.

Reset:

To reset the door, the inside and outside sensor area must be clear of any person(s) or object(s).

1. Press and hold the Record logo
2. Keep it pressed whilst the software version is displayed
3. When '**Reset Yes/No**' appears, press the Record logo
4. The door will return to its closed position and reset

NO ENTRY

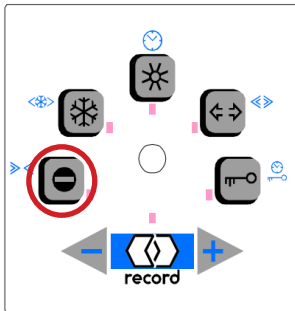

Allows People To Leave But Not Enter

WINTER MODE

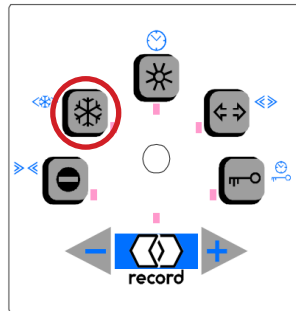

Reduced Opening Size To Save Heating

AUTOMATIC

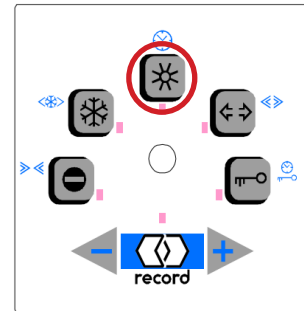

Normal Daytime Operation

HOLD OPEN

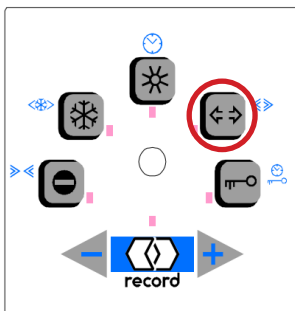

Press Once = Hold Open
Press Twice (Flashing) = Manual Mode

LOCKED

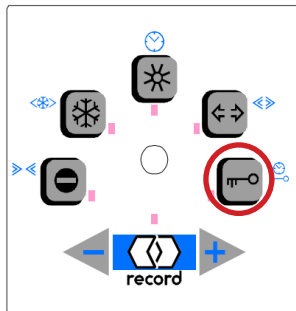

Night Setting - Doors Closed Locked

SETTING LOCKED

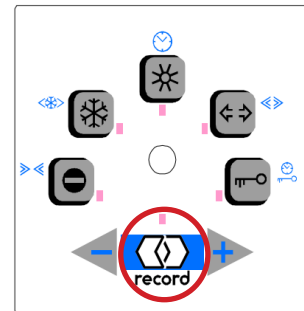

Follow The Below Procedure

To lock the programme selector

Press Press Press =

Light above the Record logo remains on with the selected programme setting

To unlock the programme selector

Press Press Press =

Light above the Record logo turns off